

Mechanical Pulse Tools

Virtually No Torque Reaction Up To 650Nm



Remote Control Quick-Set Features

Program Setting

60 unique torque controlled algorithms – 30 stages in L1 mode and 30 stages in L2 mode + F mode (non shut-off mode)

Flush Point Detection (L1/L2)

Determines when the CPU declares the flush point of the fastening process.

L1 – Applications with no pulses before the flush point or when fastening fragile materials like plastic.

L2 – Applications where tool pulses before achieving the flush point encountered in many prevailing torque and varying joint rate applications.

Rehit Prevention

Disables tool for a period of time (up to 3 sec. in 1/10 sec. intervals) after a good fastening shutoff, preventing operator from double hitting the fastener.

Out of Range / Anti-Theft

When enabled, the tool will not function if taken out of the wireless range of the qualifier. Available on models equipped with radio transmitters only.

Enable / Disable Capable

Remotely enable/disable tools when needed with qualifier + radio tool combination.

EYFNA1 and EYFPA1 Series Only

Prevent and Detect Cross Threads and Rehits

The tool first reverses 360 degrees, aligning the threads, greatly reducing the possibility of cross threads.

Maintenance Interval Alarm

Defined in 10,000 increment cycles to notify the operator of upcoming scheduled maintenance.

Speed Control Setting

Enables variable speed or single speed trigger operation.

LED Light

Program LED to turn on with trigger switch or on/off switch to match operator preference.

Buzzer

The buzzer can be programmed for OK, NOK, or disabled.

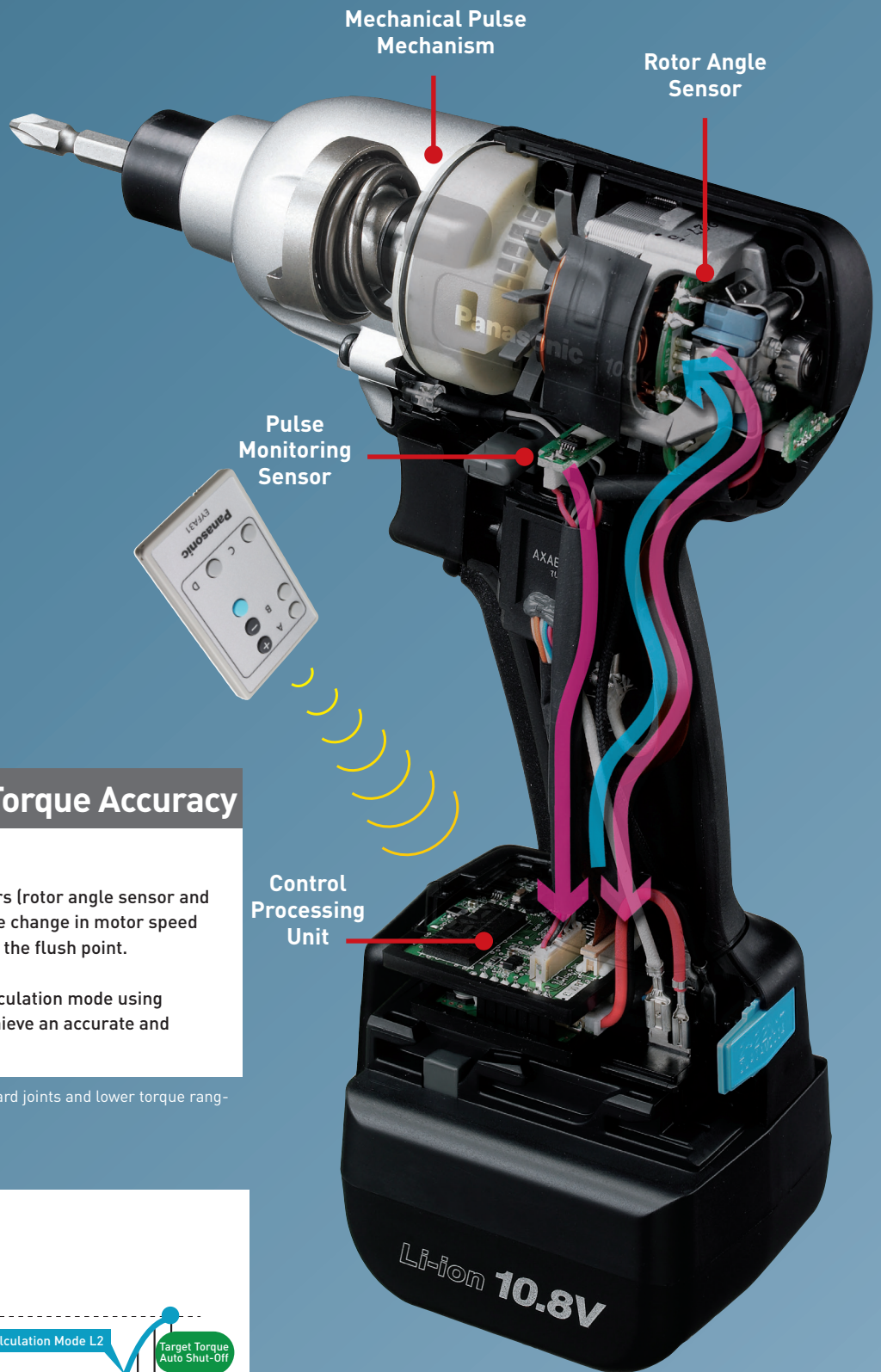

Shut-off Tool Delivers Torque Accuracy

Torque Control Mechanism

1. The onboard CPU monitors two sensors (rotor angle sensor and pulse monitoring sensor) detecting the change in motor speed and rpm between pulses, determining the flush point.
2. The CPU then switches to a torque calculation mode using a Panasonic patented algorithm to achieve an accurate and repeatable final torque.*

*Final results may have higher torque ranges with hard joints and lower torque ranges with soft joints

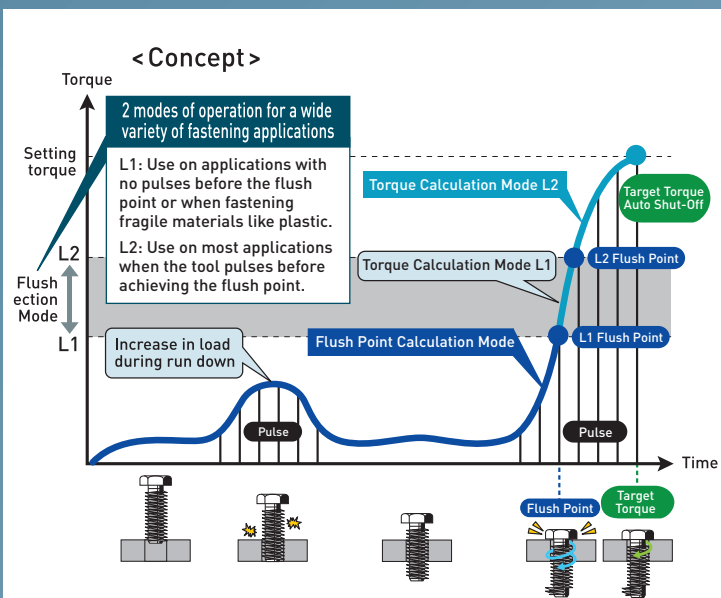

Long-life Parts Provide Lower Running Costs

Durable Hybrid Switch and Brushless Motor

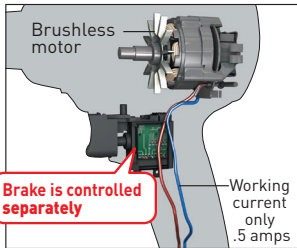

Hybrid Switch

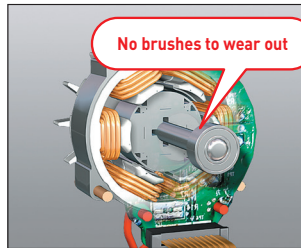

Brushless motor

Needle Bearings



Needle bearings on output shaft reduce vibration and increase tool life.

Choice of compact 2.0Ah or high capacity 3.0/4.2/5.0Ah batteries

KOMPAKT



10.8V 2.0Ah



14.4V 2.0Ah

HOHE KAPAZITÄT



10.8V 3.0Ah



14.4V 4.2Ah



18V 5.0Ah



21.6V 4.2Ah

Additional charging is acceptable

No Memory Effect

Panasonic Li-ion batteries won't deteriorate if charged during break or for a short period of time then put back into operation.



60 unique torque controlled algorithms - 30 stages in L1 mode and 30 stages in L2 mode + F mode (non shut-off mode)

Maintains selected torque level as the battery power drops.

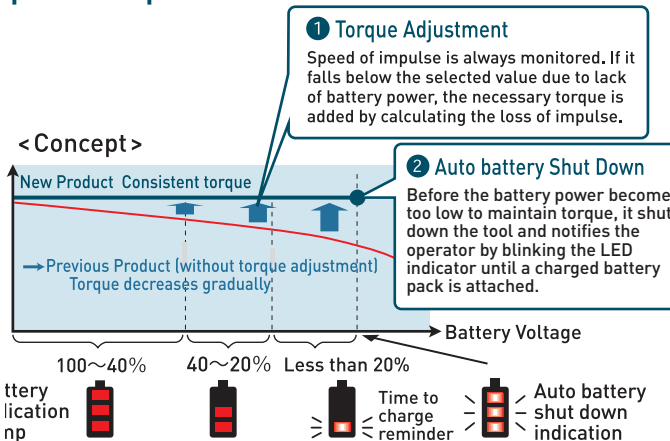

Retightening Prevention Function

Maintain strict quality control

This function prevents the tool from operating within a selected time period after it automatically stops from the torque control function. The switch will not operate even if engaged during this time period.

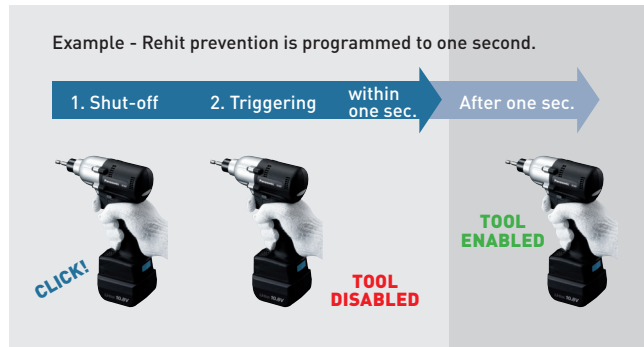

More Features



Lightweight

A well-balanced, lightweight design means workers will experience less muscle fatigue during continuous use.



Remote Control

Tool setting can be set only by remote control.



LED Light

For operations in dimly lit places

Color Plate for Differentiation

Each tool model is color coded for easy identification.



Mechanical Pulse Tools



Wireless Connectivity



High Torque 18V & 21.6V Cordless Mechanical Pulse Tools

Virtually No Torque Reaction

- M16 Bolt up to 400Nm
- M24 Bolt up to 650Nm



21.6V EYFPA

Torque controlled range
160~**650Nm**

Lightweight
approx. **3.6 kg**

High capacity
4.2Ah

18V EYFNA

Torque controlled range
70~**200Nm**

Lightweight
approx. **3.0 kg**

High capacity
5.0Ah

Advanced Technologies Delivering a Compact, Lightweight Tool with High Torque

High Efficiency Twin Hammer

New high efficiency twin hammer design delivers high power while reducing tool size, noise, vibration for reduced operator fatigue

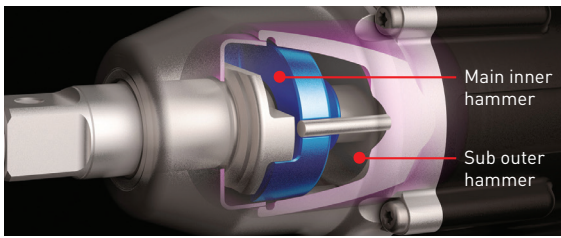

Compact, High-Powered Brushless Motor

Compact and high-power brushless motor accomplishes heavy load applications.

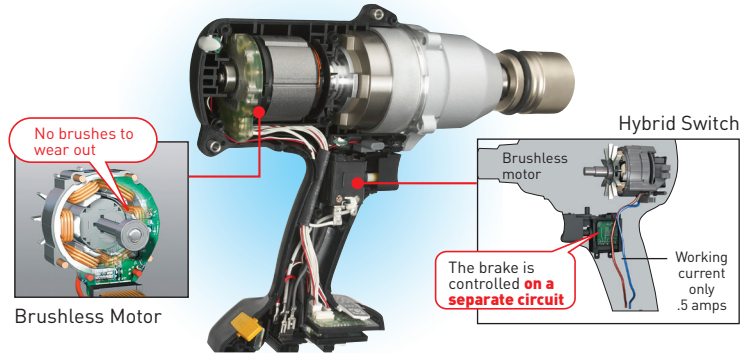

Advanced Fastening Features

Cross Thread Reduction
The tool first reverses 360 degrees, aligning the threads, greatly reducing the possibility of cross threads.

Cross thread

Reverse Rotation!

360° reverse rotation before fastening → The screw's threads are aligned with hole → Automatically shifting to normal rotation

Cross Thread / Rehit Detection
If shut-off is activated before the programmable minimum runtime, the tool alerts the operator to a NOK fastening. (Time setting: 0.1-3.0sec, 0.1sec per stage)

Retightening Cross thread

•Example with 3.0sec. normal time setting

OK	NOK	NOK
3.0sec.	2.0sec.	0.5sec.
Finished with 3.0sec. rundown time	Finished with 2.0sec. rundown time due to cross thread	Finished with 0.5sec. rundown time due to retightening

Maintenance Interval Alarm
When the fastenings are within 10,000 fastenings of the preset maintenance interval, the display blinks notifying the operator. Once tool reaches the preset interval, the tool is locked out from further use. This function can be set ON or OFF and is defined in 10,000 increment cycles. (Number of setting: 0-990,000 pcs)

Auto Battery Shut Down
Before battery power becomes too low to maintain torque, tool automatically shuts down. Blinking LED notifies operator until a charged battery is attached.

Speed Control Function
Speed can be controlled from trigger. Speed control function ON and OFF can be selected by remote.

Additional Features

Ergonomic, computer-aided design for optimal balance and operator comfort



LED Light
Program LED to turn on with trigger switch or ON/OFF switch to match operator preference



Non-skid rubber grip

Tool Hanger (Optional)







Suspend tool vertically or horizontally from a balancer



Tightening Confirmation Lamp
OK/NOK both visual and audible indicators. Buzzer ON/OFF can be selected.

*Final results may have higher torque ranges with hard joints and lower torque ranges with soft joints.

Mechanical Pulse Tools

MODELS		EYFLA4A	EYFLA4AR	EYFLA5A/EYFLA5B	EYFLA5AR	EYFLA6B/EYFLA6J	EYFLA6JR
							
Voltage		10.8V	10.8V	10.8V	10.8V	10.8V	10.8V
Shut-off method		Mechanical Pulse - SR Series					
Drive		A = 1/4" Hex Quick Change	A = 1/4" Hex Quick Change	A = 1/4" Hex Quick Change P = 3/8" Sq. Pin Detent	A = 1/4" Hex Quick Change P = 3/8" Sq. Pin Detent	J = 1/2" Sq. Through Hole P = 1/2" Sq. Pin Detent	J = 1/2" Sq. Through Hole P = 1/2" Sq. Pin Detent
Torque Range	Nm	3-22Nm	3-22Nm	6-30Nm	6-30Nm	16-53Nm	16-53Nm
	ft. lbs.	2.2-16.2 ft. lbs.	2.2-16.2 ft. lbs.	4.4-22 ft. lbs.	4.4-22 ft. lbs.	11.8-39 ft. lbs.	11.8-39 ft. lbs.
	in. lbs.	26.55-194.72 in. lbs.	26.55-194.72 in. lbs.	53.1-265.52 in. lbs.	53.1-265.52 in. lbs.	141.61-469.09 in. lbs.	141.61-469.09 in. lbs.
Max Torque (F mode, tightening 3 sec.)		Approx. 40Nm M10 Bolt	Approx. 40Nm M10 Bolt	Approx. 90Nm M14 Bolt	Approx. 90Nm M14 Bolt	Approx. 120Nm M14 Bolt	Approx. 120Nm M14 Bolt
Flush Detection Modes		L1-L2	L1-L2	L1-L2	L1-L2	L1-L2	L1-L2
No Load Speed (Torque Setting : RPM)		1: 0-950 2: 0-1300 3: 0-1450 4-8: 0-1550 9-30 & F: 0-2300	1: 0-950 2: 0-1300 3: 0-1450 4-8: 0-1550 9-30 & F: 0-2300	1: 0-1300 2: 0-1450 3: 0-1550 4-30 & F: 0-2300	1: 0-1300 2: 0-1450 3: 0-1550 4-30 & F: 0-2300	1-30 & F: 0-2300	1-30 & F: 0-2300
PPM (Pulses Per Min)		1: 0-1900 2: 0-2500 3: 0-2800 4-8: 0-3000 9-30 & F: 0-4000	1: 0-1900 2: 0-2500 3: 0-2800 4-8: 0-3000 9-30 & F: 0-4000	1: 0-2500 2: 0-2800 3: 0-3000 4-30 & F: 0-3600	1: 0-2500 2: 0-2800 3: 0-3000 4-30 & F: 0-3600	1-30 & F: 0-3000	1-30 & F: 0-3000
Weight		1,15 kg (incl. 2.0Ah EYFB32) 1,30 kg (incl. 3.0 Ah EYFB30)	1,15 kg (incl. 2.0Ah EYFB32) 1,30 kg (incl. 3.0 Ah EYFB30)	1,15 kg (incl. 2.0Ah EYFB32) 1,30 kg (incl. 3.0 Ah EYFB30)	1,15 kg (incl. 2.0Ah EYFB32) 1,30 kg (incl. 3.0 Ah EYFB30)	1,25 kg (incl. 2.0Ah EYFB32) 1,40 kg (incl. 3.0 Ah EYFB30)	1,25 kg (incl. 2.0Ah EYFB32) 1,40 kg (incl. 3.0 Ah EYFB30)
Size (L x W x H)		158 mm x 59 mm x 231mm (EYFB32B) 158 mm x 59 mm x 248mm (EYFB30B)	158 mm x 59 mm x 231mm (EYFB32B) 158 mm x 59 mm x 248mm (EYFB30B)	158 mm x 59 mm x 231mm (EYFB32B) 158 mm x 59 mm x 248mm (EYFB30B)	158 mm x 59 mm x 231mm (EYFB32B) 158 mm x 59 mm x 248mm (EYFB30B)	172 mm x 59 mm x 231mm (EYFB32B) 172 mm x 59 mm x 248mm (EYFB30B)	172 mm x 59 mm x 231mm (EYFB32B) 172 mm x 59 mm x 248mm (EYFB30B)
Wireless Communication with assembly qualifier:		—	OK Fasten=Green light, NOK Fasten=Red light	—	OK Fasten=Green light, NOK Fasten=Red light	—	OK Fasten=Green light, NOK Fasten=Red light
LED Work Light: (ON/OFF Switch)		✓	✓	✓	✓	✓	✓
OK/NOK Light: (Green: OK / Red: NOK)		✓	✓	✓	✓	✓	✓
Rehit Prevention: (Possible to set per 0.1 sec. between 0-3 sec.)		✓	✓	✓	✓	✓	✓
Battery Indication Lamp: (3 stage)		✓	✓	✓	✓	✓	✓
Low Power Disable		✓	✓	✓	✓	✓	✓
Prevent / Detect Cross Threads & Rehits		—	—	—	—	—	—
Maintenance Interval Alarm		—	—	—	—	—	—
Variable speed On/Off Switch		—	—	—	—	—	—
LED Light Setting: On/Off or On with pull of switch		—	—	—	—	—	—
Buzzer: On / Off		—	—	—	—	—	—
Snug torque detection delay (Possible to set between 0-3 sec. 0.1 sec. per stage)		—	—	—	—	—	—
Long socket mode (h1: for 150mm socket, h2: for 250mm socket)		—	—	—	—	—	—
Work Capacity/Fastening Speed		<M6: 10 N-m, Stage: 19> (EYFB30B) approx. 1200 pcs/pack, approx. 0.7 sec/1pcs (EYFB32B) approx. 800 pcs/pack, approx. 0.7 sec/1pcs		<M8: 23 N-m, Stage: 22> (EYFB30B) approx. 800 pcs/pack, approx. 0.8 sec/1pcs (EYFB32B) approx. 540 pcs/pack, approx. 0.8 sec/1pcs		<M10: 43 N-m, Stage: 23> (EYFB30B) approx. 500 pcs/pack, approx. 0.9 sec/1pcs (EYFB32B) approx. 330 pcs/pack, approx. 0.9 sec/1pcs	
Charging Time		[Battery pack EYFB30B, Charger EY0L82B] Usable charge: approx. 35 min., Full charge: approx. 45 min [Battery Pack EYFB32B, Charger EY0L82B] Usable Charge: approx. 35 min., Full Charge: approx. 40 min					

EYFMA1B/EYFMA1J	EYFMA1JR	EYFNA1J	EYFPA1J	EYFME1C
				
14.4V	14.4V	18V	21.6V	14.4V
Mechanical Pulse - SR Series				
P = 1/2" Sq. Pin Detent	P = 1/2" Sq. Pin Detent	C = 1/2" Square Drive with Ring Retainer and Through Hole J = 1/2" Square Drive with Through Hole P = 1/2" Square Drive Pin Detent	J = 3/4" Sq. Through Hole	C = 1/2" Square Drive with Ring Retainer and Through Hole
25-100Nm	25-100Nm	70-200Nm	160-650Nm	10-53Nm
18.4-73.8 ft. lbs.	18.4-73.8 ft. lbs.	51.6-147.5 ft. lbs.	118-479.4 ft. lbs.	7.3 - 39 ft. lbs
221.27-885.07 in. lbs.	221.27-885.07 in. lbs.	619.55-1770.15 in. lbs.	1416.12-5752.98 in. lbs.	88.5 - 469,09 ft. lbs
Approx. 185Nm M14 Bolt	Approx. 185Nm M14 Bolt	Approx. 470Nm M24 Bolt	Approx. 700Nm M24 Bolt	Approx. 80Nm M14 bolt
L1-L2	L1-L2	L1-L2	L1-L2	L1-L2
1-30 & F: 0-2300	1-30 & F: 0-2300	1-30 & F: 0-2300	1-30 & F: 0-2300	0 ~2300
1-30 & F: 0-3200	1-30 & F: 0-3200	1-30 & F: 0-2200	1-30 & F: 0-2200	0 ~3500
1.3 kg (incl. 2.0Ah EYFB41) 1.5 kg (incl. 4.2Ah EYFB42)	1.3 kg (incl. 2.0Ah EYFB41) 1.5 kg (incl. 4.2Ah EYFB42)	3.0 kg (incl. 5.0Ah (EYFB50B))	3.6 kg (incl. 4.2Ah (EYFB60B))	1.5 kg (incl. 2.0Ah EYFB41) 1.7 kg (incl. 4.2Ah EYFB42)
172 mm x 59 mm x 231 mm (EYFB32B) 172 mm x 59 mm x 248 mm (EYFB30B)	172 mm x 59 mm x 231 mm (EYFB32B) 172 mm x 59 mm x 248 mm (EYFB30B)	233 mm x 77 mm x 286 mm	233 mm x 77 mm x 286 mm	381 mm x 96 mm x 60 mm (EYFB41B) 399 mm x 96 mm x 60 mm (EYFB42B)
—	OK Fasten=Green light, NOK Fasten=Red light	—	—	—
✓	✓	✓	✓	✓
✓	✓	✓	✓	✓
✓	✓	✓	✓	✓
✓	✓	✓	✓	✓
✓	✓	✓	✓	✓
—	—	✓	✓	✓
—	—	✓	✓	✓
—	—	✓	✓	✓
—	—	✓	✓	✓
—	—	—	—	—
—	—	—	—	—
<M12: 71 N-m, Stage: 22> (EYFB42B) approx. 780 pcs/pack, approx. 0.9 sec/1pcs (EYFB41B) approx. 350 pcs/pack, approx. 0.9 sec/1pcs		<M12: 100 N-m, Stage: 13> approx .500pcs/pack	<M16: 180 N-m, Stage: 6> approx .450pcs/pack	<M10: 53 N-m, Stage: 25> (EYFB42B) 250 pcs/pack, 2.2 sec/1pcs(EYFB41B) 120 pcs/pack, 2.2 sec/1pcs
[Battery pack EYFB42B, Charger EYOL82B] Usable Charge: approx. 50 min., Full Charge: approx. 60 min [Battery Pack EYFB41B, Charger EYOL82B] Usable Charge: approx. 35 min., Full Charge: approx. 40 min		Battery pack EYFB50B, Charger EYOL82B) Usable Charge: approx. 65 min. Full Charge: approx. 80 min	(Battery pack EYFB60B, Charger EYOL82B) Usable Charge: approx. 65 min. Full Charge: approx. 85 min	[Battery Pack EYFB41, Charger EYOL82B) Usable Charge: 35min., Full Charge: 40min(Battery Pack EYFB42, Charger EYOL82B) Usable Charge: 50min., Full Charge: 60min

Assembly Tool Accessories

Batteries & Chargers



EY9L20B
7.2V 1.5Ah Li-ion
Battery Pack



EYFB32B
10.8V 2.0Ah Li-ion
Battery Pack



EYFB30B
10.8V 3.0Ah Li-ion
Battery Pack



EYFB41B
14.4V 2.0Ah Li-ion
Battery Pack



EYFB42B
14.4V 4.2Ah Li-ion
Battery Pack



EYFB50B
18V 5.0Ah Li-ion
Battery Pack



EYFB60B
21.6V 4.2Ah Li-ion
Battery Pack



EY0L20B
7.2V Charger



EY0L82B
10.8V - 28.8V Charger

Protector Covers



EYFA02-H
Battery Protector
for EYFB30B



EYFA03-H
Battery Protector
for EYFB32B



EYFA04-H
Battery Protector for
EYFB40B/EYFB42B

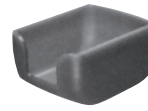

EYFA06-H
Battery Protector
for EYFB41B



EYFA10-H
Battery Protector
for EYFB50B



EYFA08-H
Battery Protector
for EYFB60B



EYFA05
EYFG Tool Protectors
-A (blue) -Y (yellow)
-H (gray)



EYFA01
EYFLA4/5/6, EYFMA1 Tool Protectors
-A (blue) -Y (yellow)
-H (gray) -G (green)



EYFA09
EYFNA Tool Protectors
-A (blue) -Y (yellow)
-H (gray) -G (green)



EYFA07
EYFP Tool Protectors
-A (blue) -Y (yellow)
-H (gray) -G (green)



EYFA13
EYFLA7/8/9, EYFMA2 Tool Protectors
-A (blue), -Y (yellow)
-H (gray), -D (orange) -G (green)



EYFA12
EYFME Tool Protectors
-A (blue), -Y (yellow)
-H (gray), -G (green)

Accessories



EYFA32B
Clutch Adjustment Tool
for EYFG Series Tools



EYFA40B
EYFG
Tool Hanger



EYFA41B
EYFN/EYFP
Tool Hanger



WEYFEA1N3137
Clutch Lock Out Cover
for EYFEA1N



EYFA31B
Remote Control for
all EYFG/EYFL/
EYFM/EYFN/EYFP Tools